

I like to screw the rails (with the threaded inserts) to the sides first then wood glue the top and bottom on. Making sure to get sufficient glue on all mating surfaces, put some books as weights on it or use clamps if you have them. Wipe off excess glue with a damp rag. Leave for 12hours. Woodglue the back and front on, with weights/clamps and leave for another 12hours.

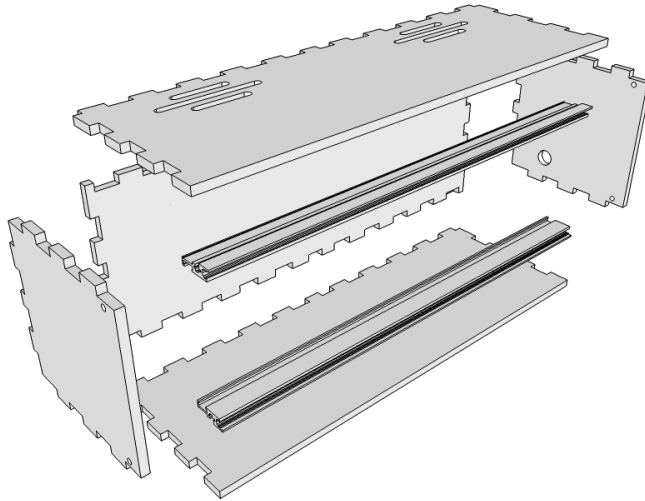

With the closing case with a lid:

The 4 corner screws, need to protrude a little further out so the lid doesn't slide all the way down. Included are 4 knurled washers that should be used on the corners.



The Lid can be a little fiddly.

I like to lay down some plastic(bags) and glue all 5pieces of wood together at the same time. The big piece flat on the table and the 4sides standing on top. Don't use too much glue here as you will have to let it sit for 12hours, seeping glue may bond to the table. When you have applied the glue and placed all pieces together slide the case down on top, making sure the protruding corner screws stop it sliding all the way. If you have some clamps, straps or even a few belts lashed together, clamp the lid sides around the case. Use books/weights on all sides if you don't have any. Leave the case in the upside down lid for 3-4hours then remove. Leave the lid to sit for a further 6hours. Go back over the joins, particularly at the inside corners, with more wood glue... Run a bead all the way around the inside join, wipe off excess with a damp cloth. Let it set for at least 8 hours.

The elastic ends should be fed into the slots from the outside and knotted together on the inside so a smooth loop can be placed around the case when closed.



Best to drill holes (4mm dia), if not precut, for the handle with the lid on the case. Use the lasercut standoff as a guide. Find the centre of the case by measuring 220mm in from either side. Place the standoff over the centremark and use a pencil to mark out the holes. Drill the 4mm holes for the screws. The screws need to be cut/broken off, to length with plyers, depending on how many standoffs you use.



I use 2 standoffs on the inside of the case and one on the outside. Screw the handle on and you are ready to wiggle...